

Operating instructions

**Frame insert
with 1 motor**



**HÜSLER
NEST**

Good night. Good day.

Device overview

Power supply unit

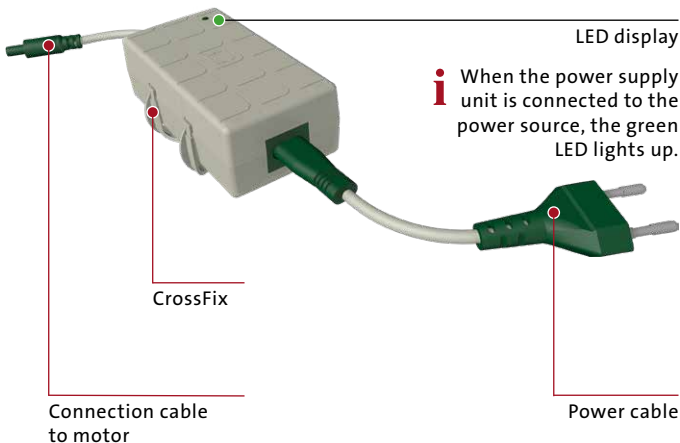

CrossFix

Fixing hole for the supplied screw.

i For elevated mounting of the power supply unit, e.g. on the baseboard or at the back side of the bedside table.

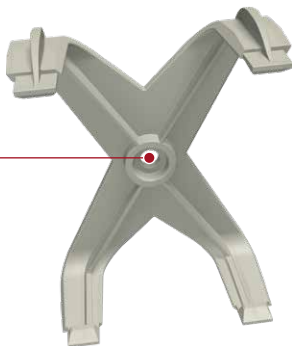

Cable handset



Technical specifications

Input voltage	100 – 240V 50 – 60Hz ~2,5 A
Output voltage	24V --- 3A
Number of motors	1
Type of motor	24 V DC
Maximum load (evenly distributed over the entire lying surface)	150 kg
Power of the motor	7500 N
EC1275/2008 Standby	< 0,21 W
Protection class of the complete system	IP 20
Recommended room temperature	+10° C bis +40° C
Relative humidity	30% – 75%
Manufactured according to VDE protection class II	✓
Tested by LGA for safety	✓

Commissioning

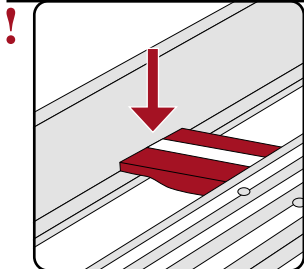

Important! All six support points of the frame insert must be in the correct position (side rails/centre support).

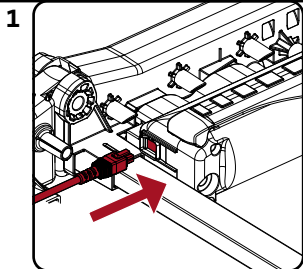

1 Connect the plug of the cable handset to the plug socket on the motor. Ensure that the plug hook is correctly aligned with the plug socket.

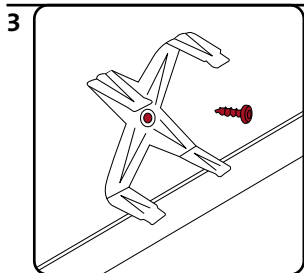

3 Mount the CrossFix bracket in the desired position.

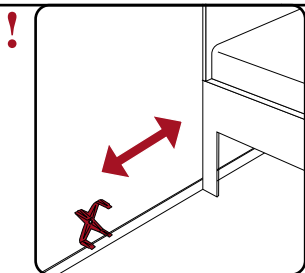

NB: Mount the CrossFix bracket preferably as far away from the bed as possible.

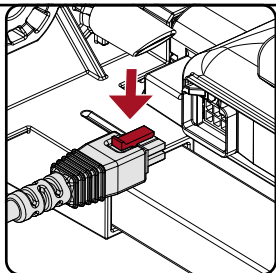

NB: The plug can only be removed if the plug hook is pressed and the plug is pulled out of the plug socket on the motor at the same time.

2

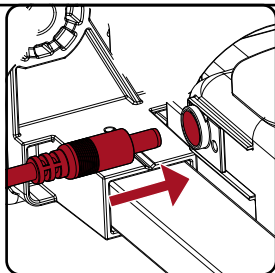

Connect the round plug of the power supply unit to the round plug socket on the motor.

4

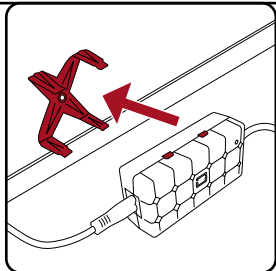

Attach the power supply unit to the CrossFix.

5

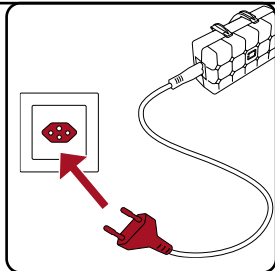

Connect the power supply unit to the power source (socket). Make sure that the power supply unit is not damaged by other objects when manoeuvring the bed.

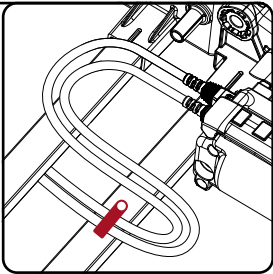

The supply cables are delivered with a strain relief already preinstalled.



NB: Avoid any compression of the cable. Make sure that none of the cables can be crushed and damaged later on when the bed is adjusted.

Manual emergency lowering in case of power failure

- ! Remove the mattress and spring unit.
- There must be no person in the bed.

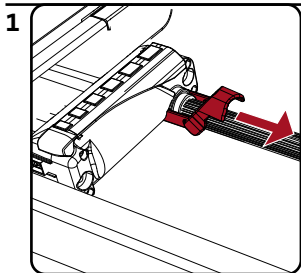

Pull the red lever towards the centre of the bed.

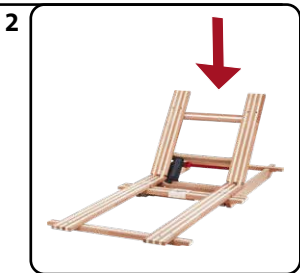

With the lever pulled,
press down to the horizontal
position (increased force
may be required).

-
- i** As soon as the power is restored, the system can be operated as usual (a short, loud noise when the cable handset is actuated for the first time after a power failure is normal – this happens when the gear wheel on the motor engages).

Important notes

- The drive technology is not suitable for continuous operation.
The system must not be operated for longer than 2 minutes at a time. After a continuous operation of 2 minutes, a minimum break of 10 minutes must be observed.
- To avoid damaging the gears of the drive mechanism, overloading of the head end must be avoided.

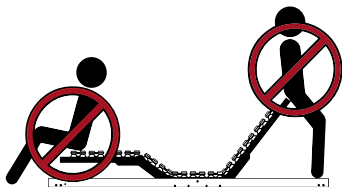

Care and maintenance

If necessary, clean the frame insert with a dry cloth.

NB: pull out the mains plug beforehand!

The entire system is maintenance-free.

Functional faults

Remedy	Malfunction
Motor does not work.	<ul style="list-style-type: none">• Check power supply to socket.• Check power plug.• Check the plug at the power supply unit.• Check both plugs on the motor.• Carry out recommissioning.
Head section cannot be moved to the full extent.	<ul style="list-style-type: none">• Check the working space of the frame parts.

If the malfunction cannot be corrected with the above measures, please contact your Hüsler Nest partner.

To check the power supply to the socket, contact your electrician.

Disposal



Discarded appliances must be rendered unusable immediately. Pull out the mains plug and disconnect the mains cable. Return electrical appliances to the sales outlet or to a collection point.



The device is not household waste. It must be disposed of in accordance with local regulations.

